



Natural Stone
Made Simple



Global Stone
RESOURCE

Contents

- 04 What is Global Stone Resources natural stone paneling system?
- 05 Why use the our natural stone paneling system?
- 07 3D Range
- 13 Contemporary Range
- 19 Crafted Range
- 25 Traditional Range
- 33 Construction Methods
- 35 Installation, Care & Maintenance





Contemporary Range Charcoal



Contemporary Range charcoal

What is our natural stone paneling system?

Our natural stone panelling system is designed by experienced stone masons specifically to create a distinctive, natural stone finish wherever it is used.

The panels rise in interlocking tiers, fitting seamlessly together, eliminating the need for specialized labour and making a quick and easy system to use.

The product is made from natural stone and is available in a variety of finishes ranging from classic to contemporary. The panels are ideal for both interior and exterior applications.

Why use our natural stone paneling system?

Authentic, real, natural stone

Our natural stone panelling systems are made from natural stone, so it bears all the form and character of a traditional masonry wall.

Part of what makes it unique is that it has been designed and developed by professional stone masons. Only the highest quality natural stones are used to produce each panel. Each stone is carefully selected and dressed before use, so no two panels are the same.

Using natural limestone, slate, quartz, granite, basalt or sandstone our masons adhere to strict guidelines to create products with subtle colour blends while maintaining traditional masonry methods to produce a consistent and authentic appearance.

The simple yet clever panel designs of our Panel System allows each section to interlock seamlessly together, producing all the charm and elegance of a natural stone surface.

Quality manufacturer

Quality raw materials and attention to detail are just some of the reasons our stone panels create such a unique, timeless and elegant finish.

All our products must pass stringent quality control procedures as well as meeting colour variance guidelines. These standards ensure a high-quality product and result in a stunning finish on any application.

Along with all the added benefits comes piece of mind. Such is our confidence in our products; our Panel System comes with a 15 and 25-year warranty.



25 Year
System
Warranty



Simple, efficient installation

This panel system has been designed to achieve the look of a stone wall without the need for a qualified stone mason. No specialized skills are required to install, which is why it is popular with both contractors and developers alike.

The modular design reduces the amount of time required to clad a wall in stone. It is possible to install up to 325 square feet per day. This compares with 35 square feet for traditional full bed masonry.

As well as reduced labor costs, it has the advantage of producing less waste during construction. While traditional stone masonry can have up to 25% wastage, our stone panels have virtually none.



3D Range

3D Range

3D Range consists of Flat Panels and Corners and are all made from natural stone, therefore suitable for interior or exterior applications. Comprised of precision-cut natural stone, these interlocking contemporary panels are hand-assembled with absolute precision. The result is a thin stone veneer that, when completed, will leave you with a new feeling of modernity and class. These contemporary 3D Panels are perfect for commercial and residential facades, fireplaces, outdoor kitchens and many other applications.

Color Range



Myra Limestone



Tundra Grey



Grey Basalt

Panel Size: 21 1/4" long x 8 1/2" high

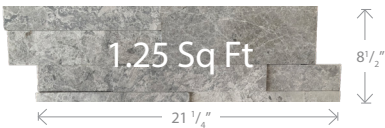

Corner Size: 13 3/4" & 7 1/2" long x 8 1/2" high

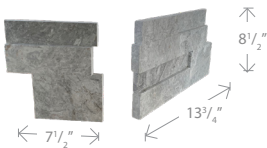

Packaging Panels & Corners

Type	Box Qty	Crate Qty	Approx. Weight
Panels	4 Flats / 5 Sq Ft	28 Boxes / 140 Sq Ft	10-12 lbs / Sq Ft
Corners	8 Corners / 5 Sq Ft	28 Boxes / 140 Sq ft	10-12 lbs / Sq Ft



3D Range Grey Basalt





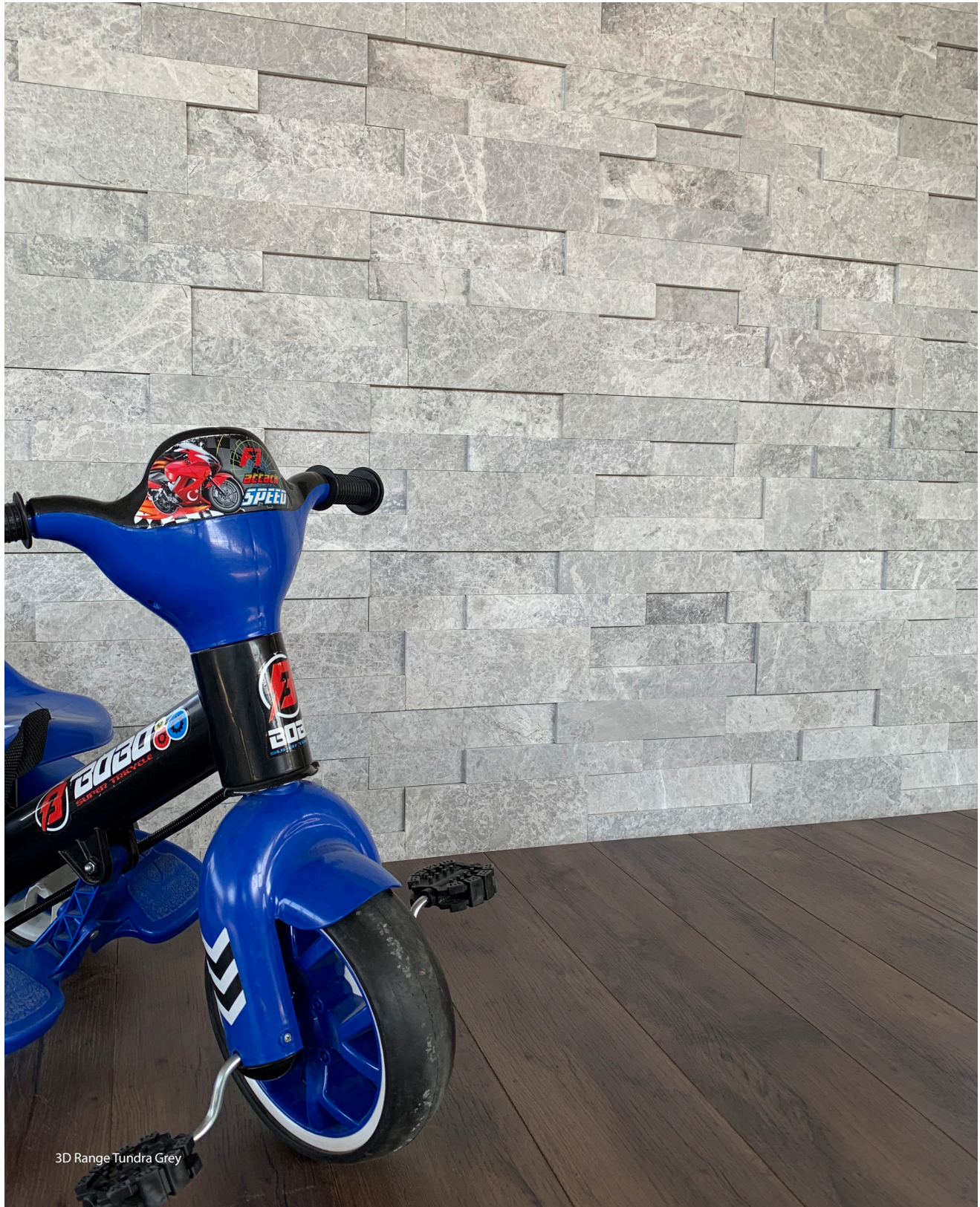

Contemporary Range

Contemporary Range

Contemporary Range Flat Panels and Corners are all made from natural stone and are suitable for interior or exterior applications. The Finger Corners are designed and manufactured in a way to achieve the most authentic-looking corner possible. Each Corner piece slides seamlessly together to create a realistic stone corner.

Color Range

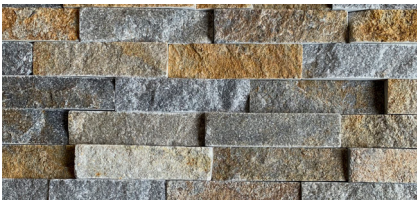

Autumn



Ochre



Milky White



Silver Black



Charcoal



Myra Limestone



Tundra Grey



Grey Basalt

Panel Size: 24" long x 6" high



Corner Size: 16" & 8" long x 6" high

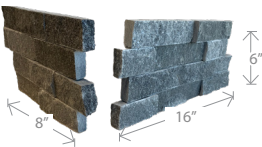

Packaging Panels & Corners

Type	Box Qty	Crate Qty	Approx. Weight
Panels	5 Flats / 5 Sq Ft	40 Boxes / 200 Sq Ft	8-10 lbs / Sq Ft
Corners	10 Corners / 5 Sq Ft	40 Boxes / 200 Sq ft	8-10 lbs / Sq Ft









Crafted Range

Crafted Range

Crafted Range consists of two components: Flat Panels and Corners. These modular panels fit seamlessly together, eliminating the need for specialized labour and make it a quick and easy system to use with virtually no waste. The panels and corners are made of natural quartzite, granite, limestone, sandstone or slate. Each panel is composed of a number of individual stones that have been dressed by hand and adhered together with high strength epoxy glue. All panels and corners are Z-shaped in order to hide the joints from view, creating an authentic stone wall appearance.

Color Range

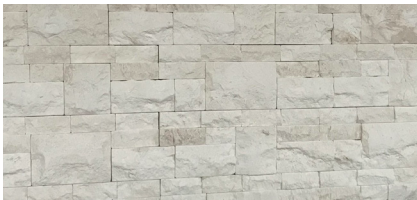

Myra Limestone

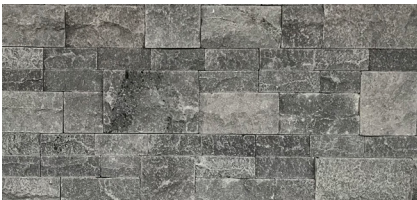

Grey Basalt

Panel Size: 21 1/4" long x 8 1/2" high

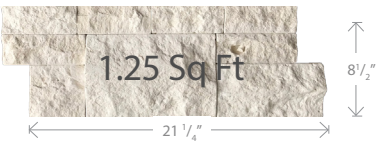

Corner Size: 13 3/4" & 7 1/2" long x 8 1/2" high



Packaging Panels & Corners

Type	Box Qty	Crate Qty	Approx. Weight
Panels	5 Flats / 5 Sq Ft	28 Boxes / 140 Sq Ft	10-12 lbs / Sq Ft
Corners	10 Corners / 5 Sq Ft	28 Boxes / 140 Sq ft	10-12 lbs / Sq Ft











Traditional Range

Traditional Range

Traditional Range consists of three components, Panels, Corners and Starter Strips; these modular shapes fit seamlessly together, eliminating the need for specialized labour. The unique panel shape and design found in our Traditional Range, eliminates any horizontal joints creating a much more seamless final look for your project.

Color Range



Nordic



Rustic Granite



Grey Slate

Starter Strip Size: 21 1/4" long x 4 1/4" high

Starter Strips are used with Panels as the first course at the base of your application. Starter Strips are also used as the first course above a window or door opening.

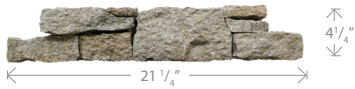

Panel Size: 21 1/4" long x 8 1/2" high



Corner Size: 10 5/8" & 10 5/8" long x 8 1/2" high



Packaging Panels & Corners

Type	Box Qty	Crate Qty	Approx. Weight
Starter Strips	8 Flats / 5 Sq Ft	28 Boxes / 140 Sq Ft	12-14 lbs / Sq Ft
Panels	4 Flats / 5 Sq Ft	28 Boxes / 140 Sq Ft	12-14 lbs / Sq Ft
Corners	4 Corners / 5 Sq Ft	24 Boxes / 120 Sq Ft	12-14 lbs / Sq Ft



Traditional Range Nordic











Traditional Range Rustic Granite

Construction Methods

Traditional Build Method

Our Panel System can be attached to a new or existing concrete or CMU structures using our Masonry Installation System.

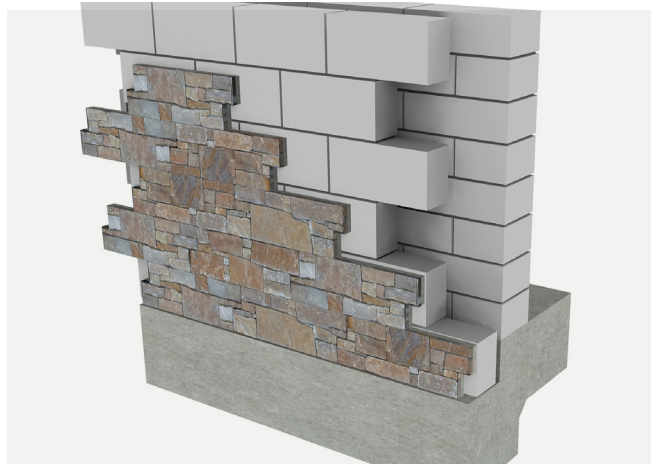

Wood Frame Method

Our Panel System can be fitted to an approved sheathing which is nailed or screwed to the structure.

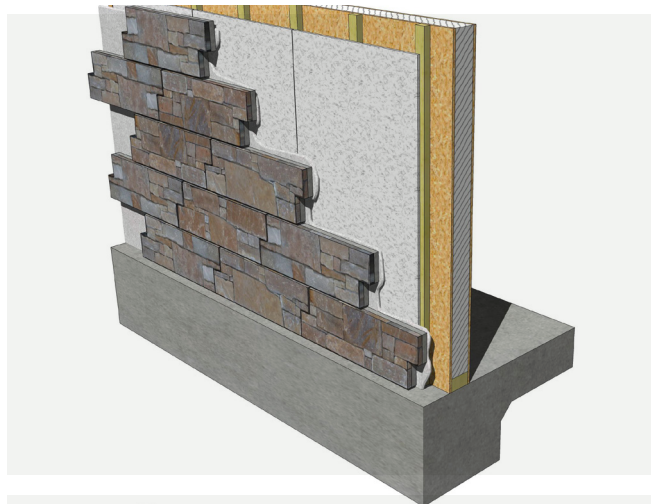

Steel Frame Method

The Steel Frame Method is similar to the Wood Frame, the only difference being the sheathing is nailed or screwed to the steel studs.

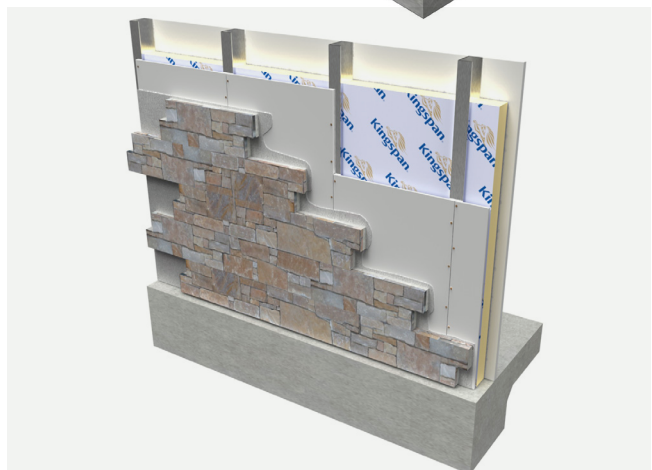

Product Specification Data

3D Range

Color	Material Type	Format	Dimensions	Pieces / Carton	Coverage / Carton	Coverage / Crate
Myra Limestone	Limestone (*refer to page 8)	Flats	21 1/4" x 8 1/2" x 1"	4	5 SF	140 SF
		2 Piece Corner	13 3/4" & 7 1/2" x 8 1/2" x 1" *	8	2.8 LF / 5 SF	78.4 LF / 140 SF
Tundra Grey	Marble (*refer to page 8)	Flats	21 1/4" x 8 1/2" x 1"	4	5 SF	140 SF
		2 Piece Corner	13 3/4" & 7 1/2" x 8 1/2" x 1"	8	2.8 LF / 5 SF	78.4 LF / 140 SF
Grey Basalt	Basalt (*refer to page 8)	Flats	21 1/4" x 8 1/2" x 1"	4	5 SF	140 SF
		2 Piece Corner	13 3/4" & 7 1/2" x 8 1/2" x 1"	8	2.8 LF / 5 SF	78.4 LF / 140 SF

Contemporary Range

Color	Material Type	Format	Dimensions	Pieces / Carton	Coverage / Carton	Coverage / Crate
Autumn	Quartz (*refer to page 14)	Flats	24" x 6" x 3/4"	5	5 Sq Ft	200 SF
		Finger Corner	16" & 8" x 6" x 3/4" *	10	2.5 LF / 5 SF	100 LF / 200 SF
Ochre	Slate (*refer to page 14)	Flats	24" x 6" x 3/4"	5	5 Sq Ft	200 SF
		Finger Corner	16" & 8" x 6" x 3/4" *	10	2.5 LF / 5 SF	100 LF / 200 SF
Milky White	Marble (*refer to page 14)	Flats	24" x 6" x 3/4"	5	5 Sq Ft	200 SF
		Finger Corner	16" & 8" x 6" x 3/4" *	10	2.5 LF / 5 SF	100 LF / 200 SF
Silver Black	Quartz (*refer to page 14)	Flats	24" x 6" x 3/4"	5	5 Sq Ft	200 SF
		Finger Corner	16" & 8" x 6" x 3/4" *	10	2.5 LF / 5 SF	100 LF / 200 SF
Charcoal	Slate (*refer to page 14)	Flats	24" x 6" x 3/4"	5	5 Sq Ft	200 SF
		Finger Corner	16" & 8" x 6" x 3/4" *	10	2.5 LF / 5 SF	100 LF / 200 SF
Myra Limestone	Limestone (*refer to page 14)	Flats	24" x 6" x 3/4"	5	5 Sq Ft	200 SF
		Finger Corner	16" & 8" x 6" x 3/4" *	10	2.5 LF / 5 SF	100 LF / 200 SF
Tundra Grey	Marble (*refer to page 14)	Flats	24" x 6" x 3/4"	5	5 Sq Ft	200 SF
		Finger Corner	16" & 8" x 6" x 3/4" *	10	2.5 LF / 5 SF	100 LF / 200 SF
Grey Basalt	Basalt (*refer to page 14)	Flats	24" x 6" x 3/4"	5	5 Sq Ft	200 SF
		Finger Corner	16" & 8" x 6" x 3/4" *	10	2.5 LF / 5 SF	100 LF / 200 SF

Crafted Range

Color	Material Type	Format	Dimensions	Pieces / Carton	Coverage / Carton	Coverage / Crate
Myra Limestone	Limestone (*refer to page 20)	Flats	21 1/4" x 8 1/2" x 1"	4	5 Sq Ft	140 SF
		2 Piece Corner	13 3/4" & 7 1/2" x 8 1/2" x 1"	8	2.8 LF / 5 SF	78.4 LF / 140 SF
Grey Basalt	Basalt (*refer to page 20)	Flats	21 1/4" x 8 1/2" x 1"	4	5 Sq Ft	140 SF
		2 Piece Corner	13 3/4" & 7 1/2" x 8 1/2" x 1" *	8	2.8 LF / 5 SF	78.4 LF / 140 SF

Traditional Range

Color	Material Type	Format	Dimensions	Pieces / Carton	Coverage / Carton	Coverage / Crate
Nordic	Quartz (*refer to page 26)	Flats	21 1/4" x 8 1/2" x 1"	4	5 Sq Ft	140 SF
		L Shape Corner	10 5/8" x 10 5/8" x 8 1/2" x 1" *	4	2.8 LF / 5 SF	67.2 LF / 120 SF
		Starter Panel	21 1/4" x 4 1/4" x 1"	8	5 Sq Ft	140 SF
Rustic Granite	Granite (*refer to page 26)	Flats	21 1/4" x 8 1/2" x 1"	4	5 Sq Ft	140 SF
		L Shape Corner	10 5/8" x 10 5/8" x 8 1/2" x 1" *	4	2.8 LF / 5 SF	67.2 LF / 120 SF
		Starter Panel	21 1/4" x 4 1/4" x 1"	8	5 Sq Ft	140 SF
Grey Slate	Slate (*refer to page 26)	Flats	21 1/4" x 8 1/2" x 1"	4	5 Sq Ft	140 SF
		L Shape Corner	10 5/8" x 10 5/8" x 8 1/2" x 1" *	4	2.8 LF / 5 SF	67.2 LF / 120 SF
		Starter Panel	21 1/4" x 4 1/4" x 1"	8	5 Sq Ft	140 SF

Abbreviated Installation Guidelines

Note: Below is an abbreviated version of the installation guidelines, the complete Installation Guidelines can be downloaded from our website.

1. Preparation

Note: Protect surface areas or plants that could be damaged during the stone installation.

Prepare the Work Area — Layout stone and materials near the installation area prior to application (25 to 30 sq.ft. of stone is typical). Layout stone to the desired blending of sizes shapes and colours similar to how it will be applied to the wall. Be sure to mix stones from different boxes and wash stone before installation (if required) to remove dust or dirt that may have gathered (especially for interior applications).

Clearances — On exterior framed walls stone should be kept a minimum 4" clearance above grade or 2" above pavement. On concrete or CMU walls maintain 2" above grade or 1/2" above pavement.

Weep Screeds — If required by local building codes, weep screeds should be of corrosion resistant materials and installed as per the manufacturer's instructions.

Flashings — Flashings and fasteners should be of corrosion resistant materials. All flashing material should be integrated with SM-BTs to prevent moisture penetration into the structure. Install in accordance with the prevailing building code, manufacturer's instructions, and or engineered details for flashing installation.

2. Mixing Mortar

Mortar can be mixed in a mortar tray, wheelbarrow, or mortar mixer. Mix to a firm, moist consistency. Mortar that is too dry and crumbly will not bond properly. Mortar that is too wet will be weak and messy.

Tip — Mortar that sticks to the trowel when held vertically is a good indicator of the right consistency. Ingredient proportions and water ratio are important. Mix in accordance with the manufacturer's instructions.

Tip — Mix mortar at the rate it can be used. If the mortar dries and stiffens before use, restore workability by adding water and remixing. Re-tempering may slightly reduce mortar's compressive strength, but bond is typically more important than compressive strength. Do not re-temper coloured mortar as it may lighten the mortar's colour.

Thin Set Mortar — (ANSI 118.4). On interior projects a thin set mortar may be used when applied over a properly prepared substrate. Note: Be sure to refer to the thin set manufacturer's recommendations to ensure selection of the correct type of thin set mortar, and for mixing and application instructions.

3. Applying the Stone

Dampen the Wall & Stone — Mist or brush the prepared substrate (scratch coat, masonry or concrete), and back of the stone (especially in hot weather). Surfaces should be damp but free of surface water. This will assist in preventing excessive moisture being drawn from the mortar. Note: Moisture absorption rates depend upon weather conditions, type of stone, and substrate.

Cold or Freezing Conditions — Protect applications from temperatures below 4° Celsius (40° Fahrenheit) as mortar will not cure properly under such conditions. Do not use antifreeze compounds to lower the freezing point of mortar.

If applying stone using a mortar setting bed – Do not spread mortar on more than a workable area (8 to 10 sq.ft.), this will avoid mortar setting up before the stone is applied. Tip — The setting bed and stones can be installed from the top down or the bottom up. Starting at the top will help avoid mortar droppings from staining the stone below. Starting from the bottom allows placement of a level temporary starter strip such as a 2"x4".

A. Apply Mortar — A 1/4" notched trowel should be used to apply 100% coverage of the wall. Also butter the back of the stone. Note: If applying mortar to the back of the stone, cover completely with mortar to avoid open pockets that may allow for the accumulation of water build up. See image on the right.

B. Place Corner Stones First — Alternate the long and short ends of each corner stone.

C. Flat Stone Placement — Install flat stones working inward from the corner stones towards the center of the wall. Tip — A temporary starter strip will assist in maintaining a uniform straight line and consistent clearance from grade and also help avoid stone slippage prior to the mortar setting up.

D. Setting Stones — Set stones firmly onto the scratch coat or setting bed applying modest pressure and wiggling slightly

Masonry Installation System

A 25-year warranty will apply when using the MASONRY INSTALLATION SYSTEM onto building structures of solid brick, stone and concrete construction.

With regards to exterior facades of ceramic tile, stone, adhered masonry veneer, or thin brick installed over external or internal substrates within buildings of any function incorporating steel or wood-framed structural features, will only qualify for a 15-year warranty.

Alternative Adhesive

For a fast no-mess solution, we recommend using Xcel Masonry Bond Adhesive. XCEL MGA is a high strength, high viscosity, one-part elastic adhesive for indoor and outdoor applications. Specifically designed for fast non-rigid structural bonding for masonry applications. It has excellent adhesion to most substrates and is entirely weather-resistant, odourless and does not contain solvents, silicones or isocyanates.





Contemporary Range Charcoal



Natural Stone Made Simple



Global Stone
RESOURCE

globalstoneresource.com
info@globalstoneresources.com
1-888-785-1222

